

CAV-FORM: INSTALLATION INSTRUCTIONS SHEET 1

1 Install cavity tie to blockwork inner leaf:
(Typically 600mm horizontal and 450mm vertical spacing)

2 Install cavity insulation

3 Install CAV-FORM spacer to secure insulation (orientate as shown)



4 Fit additional CAV-FORM intermediate spacers using "pine tree" fasteners (orientate as shown)



5 Note: ensure cavity is clean and free from debris

6 Install CAV-FORM backing boards between ties to form cavity - cut as necessary (Note: stagger board joints)

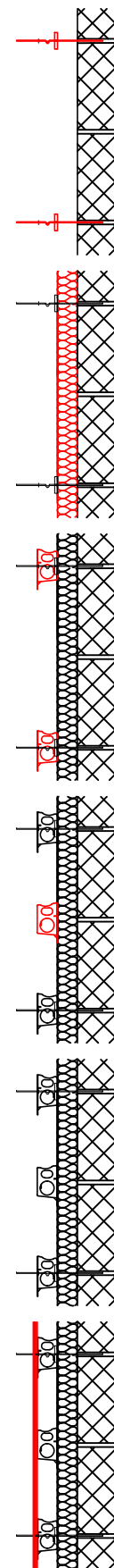

CAV-FORM: INSTALLATION INSTRUCTIONS SHEET 2

7 Secure CAV-FORM backing boards with CAV-FORM retaining clips

8 Tape vertical joints to CAV-FORM backing boards with waterproof tape (optional)

9 Tape horizontal joints to CAV-FORM backing boards with waterproof tape (optional)

10 Install masonry / random stone to form solid external course

11 Fill and seal all gaps between masonry and backing board

12 Note: Ensure cavity is covered when building next lift of inner leaf

